

KM 604HPXdrive

PALFINGER

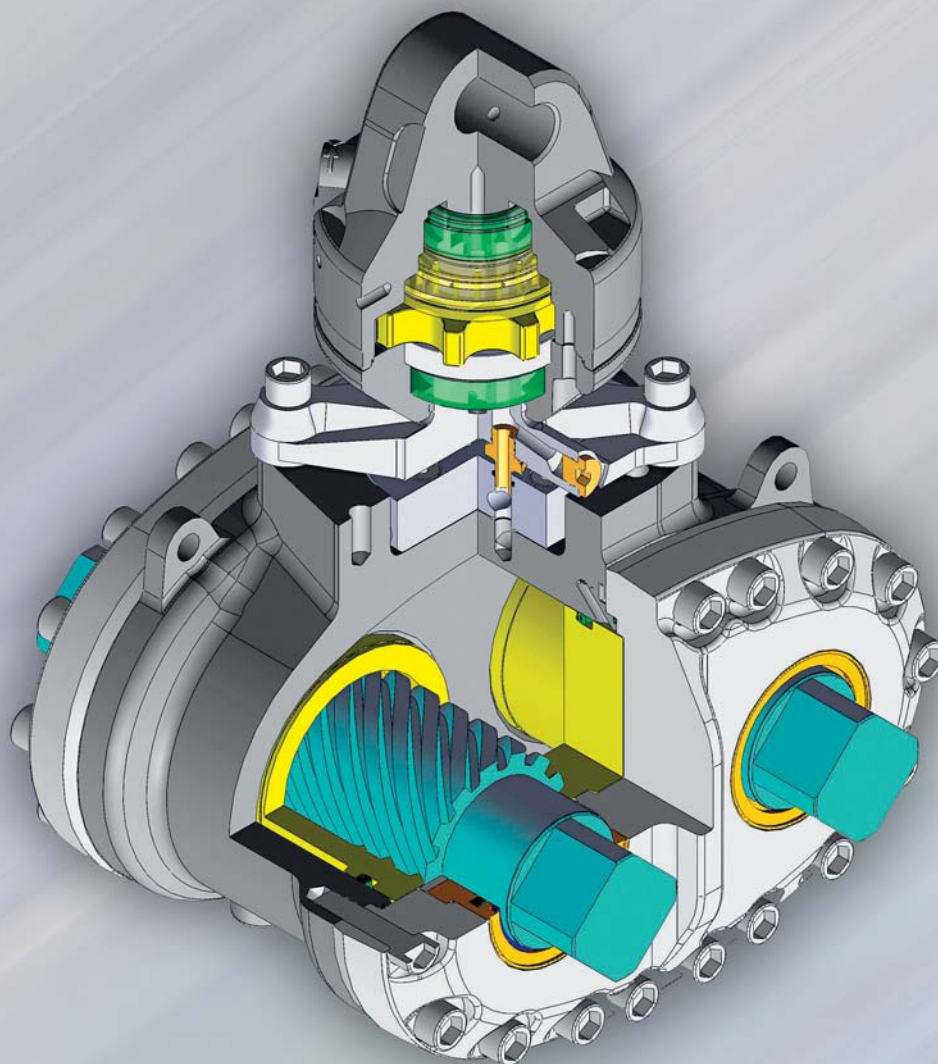

THE NEW GENERATION OF CRANE ATTACHMENTS



POWERFUL WITHOUT MAINTENANCE

The KM 604HPXdrive standard version is most suitable for daily use, with a closing force of 19 kN.

Historically the open and close functions of the attachments were activated by using hydraulic cylinders, now they are generated by two hollow shafts, which run opposed and have a helix thread, hydraulically driven by a single piston. Through the advantages of the HPXdrive – technology time is saved and the service life is extended.



Technical specifications

Closing force (of 26 MPa)	19 kN for the KM 604HPX
Torque (at 26 MPa)	11000 Nm
Recommended operating pressure	26 to 32 MPa (approx. 260 to 320 bar)
Recommended Oil Flow	25 to 75 l/min

Constant Closing Force

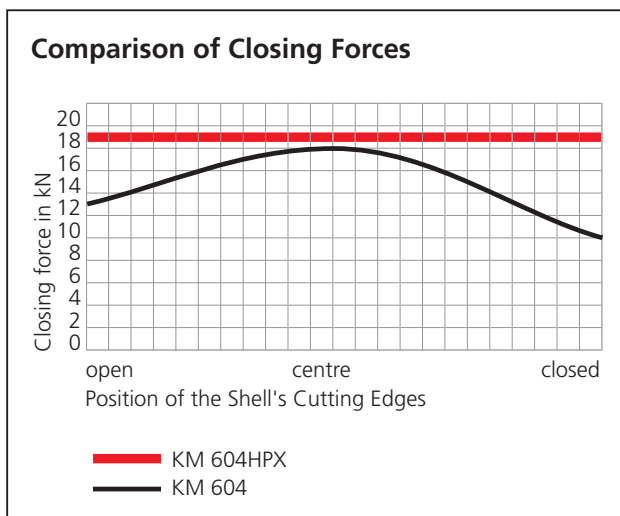

Full closing force is delivered from the beginning of the digging process, when the shells are in the opened position, ensuring powerful penetration even in grown soil. Full closing force is also provided at the end when the shells are closed, to optimally compact the material. The hydrostatic bearings for the axes increase the degree of efficiency and lead to a higher closing force.

Please note: Closing forces refer to an internal working pressure of 26 MPa (approx. 260 bar). The recommended oil pressure of 50 l/min provides an opening and closing time of 1.9 sec.

Compact Design

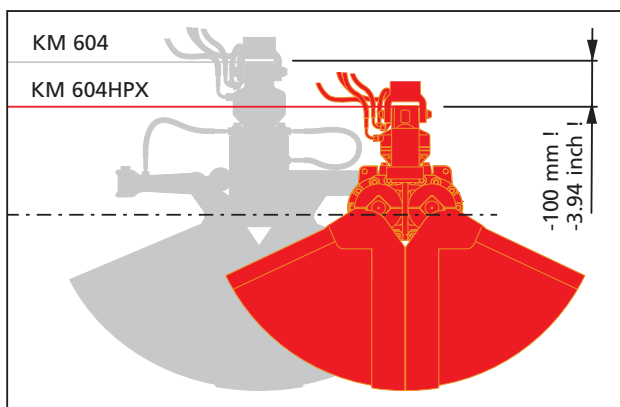

HPXdrive – the compact unit is resistant against dirt, blows and uprising material. Low overall height due to the compact design. No protruding parts. Shells are easily accessible from the top. No hoses are required in combination with a rotator with flange PZR450GF.

Rotator and HPXdrive are integrated in a single unit (internal oil passage).



FLEXIBLE SOLUTIONS

Combination with shaft-style rotator



The standard rotator for the KM 604HPXdrive is the rotator with flange PZR450GF.

In case a quick change to a non rotating hook is necessary, the HPXdrive can be delivered with the rotator with shaft PZR450G-68 – in combination with the quick change system KM 505 or reduction link N00072-68.



UL045
Upper suspension



PZR450GF
Rotator with flange



PZR450G-68
Rotator with shaft

KM 505
Quick change system



N00072-68
Reduction link



N00071-68
Non-rotating hook

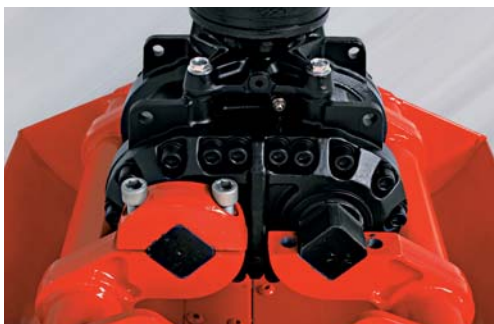

Easy exchange system

The bucket shells are bolted to the shafts, and therefore it is very easy to replace them with another set of shells. Different types of shells for different applications can be refitted onto the driving unit, e.g. clamshell bucket, timer grapple, hay and forestry grapple and multi-purpose clamshell.

EXCHANGEABLE SHELLS FOR THE HPXdrive STANDARD

Clamshell bucket – KM 604HPX

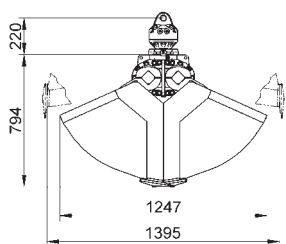

Parts-No.	Model	Capacity litre	Width mm/inches	Number of teeth required	Weight kg/lbs	Closing force kN/lbf at 26 MPa	Load capacity kg/lbs
PZWS04-200	KM 604HPX-200	200	400/15.75	4	230/506	19/4180	3000/6600
PZWS04-250	KM 604HPX-250	250	500/19.69	4	240/528	19/4180	3000/6600
PZWS04-325	KM 604HPX-325	325	600/23.62	6	265/583	19/4180	3000/6600
PZWS04-350	KM 604HPX-350	350	650/25.59	6	275/605	19/4180	3000/6600
PZWS04-450	KM 604HPX-450	450	800/31.50	6	290/638	19/4180	3000/6600

Multi-purpose clamshell – KM 604UHPX

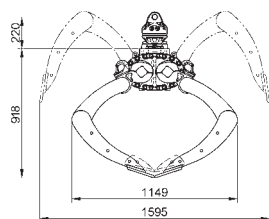

Parts-No.	Model	Capacity litre	Width mm/inches	Number of teeth required	Weight kg/lbs	Closing force kN/lbf at 26 MPa	Load capacity kg/lbs
PZWS4U-250	KM 604UHPX-250	250	570/22.44	–	320/704	18/3960	3000/6600
PZWS4U-300	KM 604UHPX-300	300	670/26.38	–	335/737	18/3960	3000/6600
PZWS4U-400	KM 604UHPX-400	400	820/32.28	–	355/781	18/3960	3000/6600
PZWS4U-500	KM 604UHPX-500	500	1020/40.16	–	375/825	18/3960	3000/6600

Rock grapple – KM 613HPX

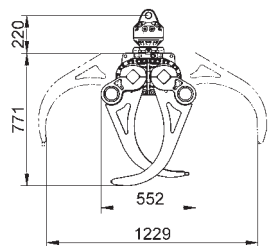

Parts-No.	Model	Capacity m ³	Width mm/inches	Number of teeth required	Weight kg/lbs	Closing force kN/lbf at 26 MPa	Load capacity kg/lbs
PZWS13-016	KM 613HPX -0,16	0.16	400/15.75	–	210/462	18/3960	1000/2200

Timber grapple – KM 632HPX

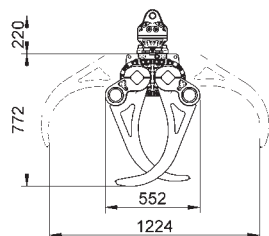

Parts-No.	Model	Capacity m ³	Width mm/inches	Number of teeth required	Weight kg/lbs	Closing force kN/lbf at 26 MPa	Load capacity kg/lbs
PZWS32-016	KM 632HPX -0,16	0.16	400/15.75	–	210/462	18/3960	1000/2200

Hay and forestry grapple – KM 641HPX

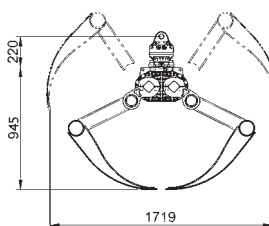

Parts-No.	Model	Capacity m ³	Width mm/inches	Number of teeth required	Weight kg/lbs	Closing force kN/lbf at 26 MPa	Load capacity kg/lbs
PZWS41-02	KM 641HPX -0,2	0.20	670/26.38	7	225/495	18/3960	1000/2200
PZWS41-04	KM 641HPX -0,4	0.40	940/37.01	7	295/649	14/3080	2000/4400